



To Protect and Promote the Health and the Environment of the People of Kittitas County

March 17, 2023

VA-23-00004 Kosar

Hello,

Any on-site septic systems that are to be utilized for wastewater management must adhere to the standards set by both the Washington Administrative Code, and Kittitas County Code.

The current septic system and designed listed reserve area is where the proposed garage will be. KCC 13.04.080, requires that no impervious surface be placed above an on-site sewage disposal system or a reserve area.

The applicant will need to propose a smaller structure or a new location.

Pursuant to KCC 13.25.020, if proposed garage with loft will include water then an Adequate Water Supply Determination will also need to be submitted.

I have attached the recorded on-site sewage system to be used as a frame of reference.

Best Regards,

A handwritten signature in black ink that reads "J.R.C." with a stylized flourish.

Joe Rainwater-Cummings, M.S., Environmental Health Specialist *(he/his/him)*

P: 509.933.8225 | F: 509.962.7581 | E: joseph.rainwater@co.kittitas.wa.us

Kittitas County Public Health Department

507 N Nanum St Suite 102, Ellensburg WA 98926

www.co.kittitas.wa.us/health

Please tell us how we're doing: [KCPHD Customer Survey](#)



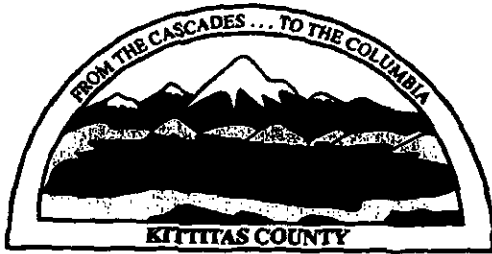

KITITAS COUNTY PUBLIC HEALTH DEPARTMENT
 Environmental Health Division
 411 N. Ruby Street Suite 3
 Ellensburg, WA 98926 (509) 962-7698

ON SITE SEWAGE INSTALLATION PERMIT

Parcel # 20-14-02051-0958

Type of Permit: New Repair Renewal Privy Type of System: Gravity Pressure Alternative

Description

First Name Last Name
Travis Els

Subdivision Division Block Lot
Pine Lock Sun 2

Site Address Parcel Size
.37

No of Bedrooms Other
2

Square Feet of Drainfield Septic Tank Capacity Pump Chamber Capacit Application Rate
720 1000 1000 .2

State Licensed Designer/PE
Calvin Beedle

Installation Contractor
MTH Constructors

Issued By
Dacia Carver

Date Issued
7/18/2006

This permit expires one year from the date of issuance. The above specifications are minimum. Changes in specifications shall be approved prior to installation. Seventy-two hours (3 business days) advance notice is required for inspections.

Inspected By
Joe Gilbert

Date Approved
7/23/08

Comments #Name?
See OSDS ✓

To Protect and Promote the Health and the Environment of the People of Kittitas County

PUBLIC HEALTH
 ALWAYS WORKING FOR A SAFER AND
 HEALTHIER KITITAS COUNTY

20-14-02051-0958

PUBLIC HEALTH DEPARTMENT

www.co.kittitas.wa.us/health/

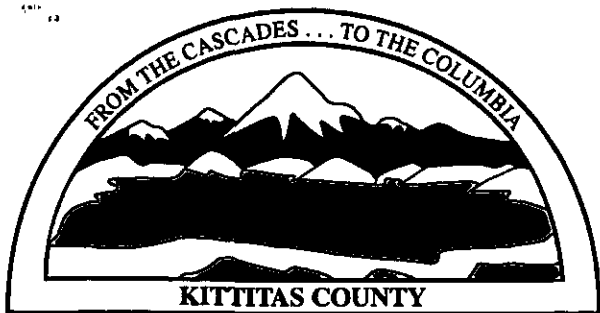

Administration
Community Health Services
Health Promotion Services
507 N. Nanum Street, Ste 102
Ellensburg, WA 98926
Phone: (509) 962-7515
Fax: (509) 962-7581

Environmental Health
411 North Ruby Street, Ste 3
Ellensburg, WA 98926
Phone (509) 962-7698
Fax (509) 962-7052

Environmental Health OSDS Form

Date: 8/3/07 EH Inspector: Joe Gilbert Designer: Calvin Beedle
Owner Name: Ells Travis
Address: Eagle View Rd
Parcel Number: 20-14-02051-0958

SEPTIC TANK

Concrete Polyethylene Fiberglass
Size: Septic Tank: 1000 Gallons Pump Chamber: 1000 Gallons Other Tank: _____

Distribution Box: Water Levelled? Yes No Manifold: _____ inches Laterals: _____ inches

DRAIN FIELD

Configuration: Trench Bed
of Laterals: 3 Width: 3' Length: 80'
Type of System: Gravel Gravelless Gravity Pressure Other: _____
Square Feet: Proposed: _____ Actual: _____
Drainfield Squirt Height: 48" Recirc/Sand Filter Squirt Height: _____

MISCELLANEOUS

Laterals Level? Yes No
Cross-Section Satisfactory? Yes No
Elevations Satisfactory? Yes No
Installation Conforms to Design? Yes No
If changed, Designer OK? Yes No List Changes:

CHECKLIST FOR FINAL

System Hardwired? Yes No
Alarm Functioning? ? Yes No
Panel Timer Set? Demand Yes No
Risers on Tanks? Yes No
Record Drawing Submitted? Date: 7/20/08 Yes No

Comments: Needs Hardware + Alarm Test and As-Built

Site Sketch / As-Built Drawing

To Protect and Promote the Health and the Environment of the People of Kittitas County

PUBLIC HEALTH
ALWAYS WORKING FOR A SAFER AND
HEALTHIER KITITITAS COUNTY

X

10
X

10/11/11
b

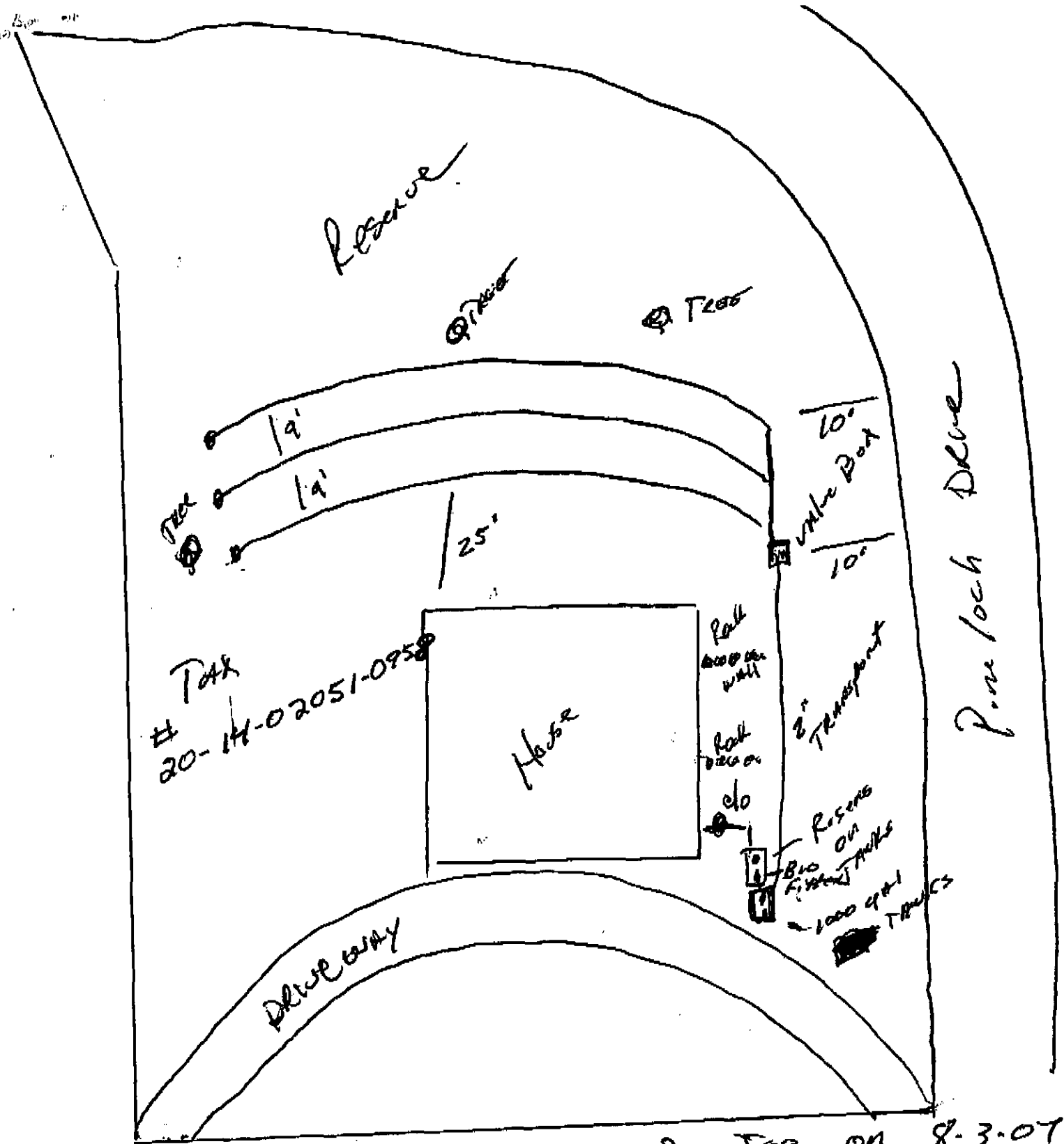

Squirt Test Done By Joe on 8-3-07
Set at 3'

31 Eagle View RD - Asbury
TRAVIS ELLS

Installed
MTH Construction



2008_0707Image0242.JPG



2008_0707Image0243.JPG



2008_0707Image0244.JPG

